

ACESSÓRIOS ELETROSOLDÁVEIS

FITTINGS





Os acessórios eletrosoldáveis Fusion Fusamatic® comercializados pela Gastrade, são inspecionados individualmente utilizando um sistema de monitorização automático através de uma avançada tecnologia de código de barras. O Código de barras permite uma rastreabilidade individual do acessório até ao lote da matéria prima utilizada no fabrico de cada acessório.

The Fusion FUSAMATIC® electrofusion fittings commercialized by Gastrade are individually inspected using a computerised monitoring system that uses an advanced barcode technology. The barcode provides full individual fitting traceability to the raw material batch used on the production of that fitting.

A utilização de acessórios eletrosoldáveis em sistemas de polietileno permite criar redes de tubo monobloco totalmente soldadas. A qualidade de produção, a fiabilidade e a flexibilidade dos acessórios eletrosoldáveis Fusion Fusamatic® garantem assim uma soldadura sem fuga assegurando o correto funcionamento do sistema para futuro.

The use of electrofusion fittings in polyethylene systems makes it possible to create fully welded monoblock pipe networks. The production quality, reliability and flexibility of Fusion Fusamatic® electrofusion fittings guarantee leak-free welding, ensuring that the system will function correctly in the future.

Dimensões Sizes

As dimensões variam desde d20 a d1200.

Size range from d20 to d1200.

Níveis de Pressão Pressure Ratings

Todos os acessórios são fabricados em polietileno preto virgem PE100 e pressão nominal até 10 bar para transporte de gás e 16/25 bar para transporte de água, salvo indicação em contrário. *All fittings are manufactured in virgin PE100 black polyethylene and pressure rated up to 10 bar for gas applications and 16/25 bar for water applications, unless stated otherwise.*

Certificações Certification

(UNI/INSTA SBC) EN1555-3 / (UNI/INSTA SBC) EN12201-3 / WRAS / DVGW GW335-B2B1 / KIWA BRL-K17105 / ACS / (UNI) ISO15494 / AS/ NZS4129, WATERMARK AND ISO TYPE 5 / KITEMARK GIS/PL2-4 / KITEMARK GIS/PL2-6 /

Classificação SDR SDR Rating

Os acessórios Fusion FUSAMATIC® são fabricados para aplicação em redes de polietileno de SDR26 a SDR11 (Acessórios eletrosoldáveis igualmente disponíveis em SDR7.4).

Fusion FUSAMATIC® fittings are manufactured for application in polyethylene pipes from SDR26 to SDR11 (Electrofusion fittings also available in SDR7.4)



A. Pino Fusamatic®

O pino Fusamatic® fornece um método totalmente automático para garantir a leitura dos parâmetros de soldadura corretos. Dentro de cada pino existe um sensor que armazena os parâmetros de soldadura de cada acessório. Quando o equipamento de eletrosoldadura é ligado ao terminal o pino permite identificar automaticamente o tempo de fusão/tensão/tempo de arrefecimento necessários para uma correta soldadura.

A. Fusamatic® pin

The Fusamatic® pin provides a totally automatic method for ensuring the correct welding parameters are used. Within each pin is a sensor.

When the electrofusion box is connected to the fitting, the pin enables it to automatically identify the correct fusion/cool time and voltage required to make the joint.



B. Testemunhos de Soldadura

A pressão gerada pelo plástico fundido em expansão na área da soldadura (dentro do acessório) durante o processo de eletrosoldadura, forçará os terminais indicadores a surgir. Este é um sinal de que a pressão necessária à soldadura foi atingida dentro do acessório no decorrer do processo de fusão.

B. Indicators

Pressure, created by the expanding molten plastic in the jointing area (inside the fitting) during the electrofusion process, will force out the indicator lugs. This is a visible sign that the necessary jointing pressure has been achieved.

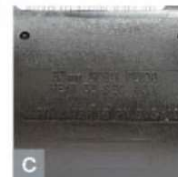

C. Marcação dos parâmetros de soldadura

Os parâmetros de soldadura manual estão marcados no corpo de todos os acessórios. A informação fornecida inclui material (PE100), SDR do tubo compatível, parâmetros de soldadura e valores nominais de pressão para aplicações em gás e água.

C. Moulded-in welding parameters

Manual welding parameters are moulded into the body of all fittings. Information provided includes fitting size, material (PE100), applicable pipe SDRs, weld parameters, and pressure ratings for gas and water applications



D. Marcação permanente do número do lote

O número do lote marcado durante o fabrico do acessório é apenas um dos identificadores de controlo de qualidade de cada acessório. Este número é também reproduzido no código de barras do acessório.

D. Permanently marked batch number

The injection moulded batch number is just one of numerous quality control identifiers on each Fusamatic fitting. That number is also replicated on the fitting's barcode.



E. Código de Barras/Código QR

O controlo de qualidade é fundamental para garantir a fiabilidade dos acessórios. A configuração do código de barras, incluindo o código QR, proporcionam uma rastreabilidade total da matéria-prima utilizada na produção de cada acessório em concreto. Para além disso, a etiqueta contém um código de acesso aos parâmetros de soldadura, transmitidos ao equipamento de eletrosoldadura através de uma leitura ótica.

E. Barcode / QR Code

Quality control is crucial to the success of these fittings. The unique barcode configuration, including QR code, provides full traceability of raw material for each individual fitting and welding information when used in conjunction with electrofusion boxes equipped with a barcode scanner.

BUREAU VERITAS
Certification



Certificate of Conformity

Awarded to:

FUSION GROUP LTD

Head Office and Operative Site:

Smeckley Wood Close – Chesterfield S41 9PZ – United Kingdom

Bureau Veritas Italia S.p.A. certifies that the following products:

Fittings in (PE)

Raw material	Dimensional groups	SDR	Groups of fittings	Products
See Annex 1/1				

Brand:

FUSAMATIC

Compound code:

E03⁽¹⁾, N20⁽¹⁾, N21⁽¹⁾, H17⁽¹⁾

⁽¹⁾For raw materials details please check www.traccoding.com

Have been evaluated and found in accordance with the requirements of the standard:

EN 12201-3:2011+A1:2012

Plastics piping systems for water supply, and for drainage and sewerage under pressure
Polyethylene (PE) – Part 3: Fittings

Certificate issued in conformity to: IT-QHSE-REG-02_ENG.TQR Bureau Veritas – Regulation for the certification of product / process / service and IND-REP-49_CP Particular regulation for the certification of plastic fluid conduction systems - Flexible scope.

Original Emission date: **09/03/2022**
Current Emission date: **26/04/2023**
Expiration date: **28/04/2026**

The validity of this certificate is subject to a constant periodical surveillance and it can be checked on the following website: **www.bureauveritas.it** - Further clarifications regarding the scope of this certificate and the applicability of standard's requirements may be obtained by consulting the organisation.

(Fabio Pes – Scheme Technical Manager)

Certificate N°: **559/003**



PRD N° 009B

Membro degli Accordi di Mutuo Riconoscimento EA, IAF e ILAC
Signatory of EA, IAF and ILAC mutual Recognition Agreements



Technical Data Sheet
Annex 1/1 to Certificate of Conformity
Bureau Veritas Italia S.p.A.
N° 559/003 of 26/04/2023

Awarded to:

FUSION GROUP LTD

Head office and Operative Site:

Smeckley Wood Close – Chesterfield S41 9PZ – United Kingdom

Raw material	Dimensional groups	SDR	Groups of fittings	Products
PE 100	1,2,3	(1)	A	Electrofusion elbows, degrees 22.5 ° - 45 ° - 90 °
PE 100	1,2,3	(1)	A	Electrofusion tees
PE 100	1,2,3	(1)	A	Electrofusion reducers
PE 100	1,2,3	(1)	A	Electrofusion couplers
PE 100	2	(1)	A	Electrofusion couplers (low pressure)
PE 100	1,2,3	(1)	A	Electrofusion couplers with end caps
PE 100	1,2,3	(1)	A	Electrofusion transition couplers
PE 100	1,2,3	(1)	A	Electrofusion transition elbow 45° - 90°
PE 100	1,2,3	(1)	B	Electrofusion tapping tees
PE 100	1,2,3	(1)	B	Electrofusion multiseal tapping tees
PE 100	1,2,3	(1)	B	Electrofusion flex tee saddles
PE 100	1,2,3	(1)	B	Electrofusion branch saddles
PE 100	1,2,3	(1)	B	Electrofusion flanged branch saddles
PE 100	1,2,3	(1)	B	Electrofusion balloon saddles
PE 100	1,2,3	(1)	B	Electrofusion transition saddles
PE 100	1,2,3	(1)	B	Electrofusion tapping valve saddles

(1) All applicable SDR

BUREAU VERITAS
Certification



Certificate of Conformity

Awarded to:

FUSION GROUP LTD

Head Office and Operative Site:

Smeckley Wood Close – Chesterfield S41 9PZ – United Kingdom

Bureau Veritas Italia S.p.A. certifies that the following products:

Fittings in (PE)

Raw material	Dimensiona groups	SDR	Groups of fitting:	Products
See Annex 1/1				

Brand:

FUSAMATIC

Compound code:

E03⁽¹⁾, E13⁽¹⁾, N20⁽¹⁾, N21⁽¹⁾, H17⁽¹⁾

⁽¹⁾For raw materials details please check www.traccoding.com

Have been evaluated and found in accordance with the requirements of the standard:

EN 1555-3:2021

Plastics piping systems for the supply of gaseous fuels
Polyethylene (PE) – Part 3: Fittings

Certificate issued in conformity to: IT-QHSE-REG-02_ENG.TQR Bureau Veritas – Regulation for the certification of product / process / service and IND-REP-49_CP Particular regulation for the certification of plastic fluid conduction systems - Flexible scope.

Original Emission date: **08/11/2010**
Current Emission date: **26/04/2023**
Expiration date: **28/04/2026**

The validity of this certificate is subject to a constant periodical surveillance and it can be checked on the following website: **www.bureauveritas.it** - Further clarifications regarding the scope of this certificate and the applicability of standard's requirements may be obtained by consulting the organisation.

(Fabio Pes – Scheme Technical Manager)

Certificate N°: **559/002**



PRD N° 009B

Membro degli Accordi di Mutuo Riconoscimento EA, IAF e ILAC
Signatory of EA, IAF and ILAC mutual Recognition Agreements



Technical Data Sheet
Annex 1/1 to Certificate of Conformity
Bureau Veritas Italia S.p.A.
N° 559/002 of 26/04/2023

Awarded to:

FUSION GROUP LTD

Head office and Operative Site:

Smeckley Wood Close – Chesterfield S41 9PZ – United Kingdom

Raw material	Dimensional groups	SDR	Groups of fittings	Products
PE 100	1,2,3	(1)	A	Electrofusion elbows, degrees 22.5 ° - 45 ° - 90 °
PE 100	1,2,3	(1)	A	Electrofusion tees
PE 100	1,2,3	(1)	A	Electrofusion reducers
PE 100	1,2,3	(1)	A	Electrofusion couplers
PE 100	2	(1)	A	Electrofusion couplers (low pressure)
PE 100	1,2,3	(1)	A	Electrofusion couplers with end caps
PE 100	1,2,3	(1)	A	Electrofusion transition couplers
PE 100	1,2,3	(1)	A	Electrofusion transition elbow 45° - 90°
PE 100	1,2,3	(1)	B	Electrofusion tapping tees
PE 100	1,2,3	(1)	B	Electrofusion multiseal tapping tees
PE 100	1,2,3	(1)	B	Electrofusion flex tee saddles
PE 100	1,2,3	(1)	B	Electrofusion branch saddles
PE 100	1,2,3	(1)	B	Electrofusion flanged branch saddles
PE 100	1,2,3	(1)	B	Electrofusion balloon saddles
PE 100	1,2,3	(1)	B	Electrofusion transition saddles
PE 100	1,2,3	(1)	B	Electrofusion tapping valve saddles

(1) All applicable SDR



MATERIAL : PE 100

Ref.	D1	D	L1	L	PN
	mm	mm	mm	mm	bar
CBKA20	20	29	37.5	77	10 16
CBKA25	25	33.5	37.5	77	10 16
CBKA32	32	43	37.5	77	10 16
CBKA40	40	51.5	44	90	10 16
CBKA50	50	61.5	44	91	10 16
CBKA5025	50	68	49	100	25
CBKA63	63	78	50	102	10 16
CBKA6325	63	82	57	118	25
CBKA75	75	92.5	59.5	122	10 16
CBKA7525	75	97	62	126	25
CBKA90	90	109.5	60	122	10 16
CBKA9025	90	117	73	148	25
CBKA110	110	133	70	144	10 16
CBKA11025	110	140	80	163	25
CBKA125	125	151	75	154	10 16
CBKA12525	125	157	97	173	25
CBKA140	140	176	89	181	10 16
CBKA160	160	195	86	175	10 16
CBKA16025	160	198	97	198	25
CBKA180	180	219	92	187	10 16
CBKA18025	180	224	104	212	25
CBKA200	200	242	92	187	10 16
CBKA20025	200	249	110	223	25
CBKA225	225	270	109	222	10 16
CBKA22525	225	280	118	240	25
CBKA250	250	300	108	222	10 16
CBKA25025	250	310	127	256	25
CBKA280	280	345	130	280	10 16

Ref.	D1	D	L1	L	PN
	mm	mm	mm	mm	bar
CBKA280	280	341	135	274	25
CBKA315	315	385	130	260	10 16
CBKA31525	315	381	140	284	25
CBKA355	355	432	132.5	265	10 16
CBKA400	400	486	145	290	10 16
CBKA450	450	521	160	320	10
CBKA450	450	560	160	320	16
CBKA500*	500*	579	180	360	10
CBKA500*	500*	621	180	360	16
CBKA560*	560*	639	195	390	10
CBKA560*	560*	695	195	390	16
CBKA630*	630*	723	215	430	10
CBKA630*	630*	780	215	430	16
CBKA710*	710*	819	237.5	475	10
CBKA710*	710*	882	237.5	475	16
CBKA800*	800*	921	260	520	10
CBKA800*	800*	993	260	520	16
CBKA900*	900*	1035	275	550	10
CBKA900*	900*	1115	275	550	16
CBKA1000*	1000*	1149	300	600	10
CBKA1000*	1000*	1238	300	600	16
CBKA1100*	1100*	1296	310	620	10
CBKA1100*	1100*	1385	310	520	16
CBKA1200*	1200*	1376	325	650	10
CBKA1200*	1200*	1483	325	650	16
CBKA1400*	1400*	1603	275	550	10

* As uniões de diâmetro superior a 500mm requerem dois ciclos de eletrosoldadura (disparo duplo), um para cada extremidade do encaixe.

* Couplers greater than 500mm in diameter require two electrofusion cycles (dual shot), one for each end of the fitting.

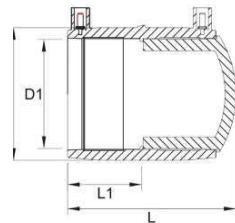

MATERIAL : PE 100

Ref.	D1	D	L1	L	PN
	mm	mm	mm	mm	bar
ECBKA20	20	29	37.5	82	10 16
ECBKA25	25	33.5	37.5	82	10 16
ECBKA32	32	43	37.5	84	10 16
ECBKA40	40	51.5	44	97	10 16
ECBKA50	50	61.5	44	101	10 16
ECBKA63	63	77	49	115	10 16
ECBKA75	75	92	59	133	10 16
ECBKA90	90	110	60	138	10 16
ECBKA110	110	133	70	164	10 16
ECBKA125	125	151	75	175	10 16
ECBKA140	140	172	79	236	10 16
ECBKA160	160	195	86	202	10 16
ECBKA180	180	220	91	214	10 16
ECBKA200	200	243	92	215	10 16
ECBKA225	225	270	109	222	10 16
ECBKA250	250	295	108	220	10 16
ECBKA280	280	340	134	396	10 16
ECBKA315	315	387	184	405	10 16
ECBKA355*	355*	443	140	515	10 16
ECBKA400*	400*	499	148	355	10 16
ECBKA450*	450*	560	155	380	10 16
ECBKA500*	500*	621	158	390	10 16
ECBKA560*	560*	695	168	420	10 16
ECBKA630*	630*	780	185	475	10 16

Ref.	D1	D	L1	L	PN
	mm	mm	mm	mm	bar
ECBKA710*	710*	882	200	520	10 16
ECBKA800*	800*	993	210	555	10 16
ECBKA900*	900*	1035	205	535	10
ECBKA1000*	1000*	1149	220	580	10
ECBKA1200*	1200*	1376	238	790	10

* Fornecimento composto por acessório topo a topo acoplado com união eletrosoldável

* Spigot fitting with electrofusion coupler supplied.

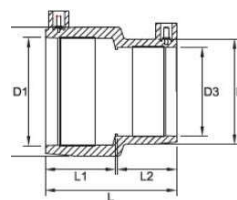

MATERIAL : PE 100

Ref.	D1	D	D2	D3	L	L1	L2	PN
	mm	mm	mm	mm	mm	mm	mm	bar
RBKA20X16	20	36	36	16	71	35	36	10 16
RBKA25X20	25	34	29	20	77	39	37	10 16
RBKA32X20	32	43	29	20	77	39	37	10 16
RBKA32X25	32	43	34	25	77	39	37	10 16
RBKA40X32	40	52	44	32	91	46	43	10 16
RBKA50X32	50	62	44	32	91	47	41	10 16
RBKA50X40	50	62	52	40	91	46	43	10 16
RBKA63X32	63	78	44	32	102	52	44	10 16
RBKA63X40	63	78	52	40	102	52	45	10 16
RBKA63X50	63	78	62	50	102	52	48	10 16
RBKA75X63	75	98	82	63	126	61	57	10 16
RBKA90X50	90	116	69	50	143	71	49	10 16
RBKA90X63	90	110	79	63	123	61	55	10 16
RBKA90X75	90	116	98	75	143	71	61	10 16
RBKA110X63	110	140	98	63	137	75	54	10 16
RBKA110X90	110	134	112	90	137	68	62	10 16
RBKA125X90	125	152	112	90	145	75	63	10 16
RBKA125X110	125	158	141	110	171	85	78	10 16
RBKA160X90	160	187	116	90	175	92	68	10 16
RBKA160X110	160	200	140	110	184	89	73	10 16
RBKA160X125	160	199	158	125	195	94	85	10 16
RBKA180X125	180	216	157	125	221	101	83	10 16

Diâmetros de 200 - 1400 mm disponíveis como artigo composto (acessório topo a topo + uniões eletrosoldáveis).

Diameters from 200 - 1400 mm available as a kit (spigot fittings + electrofusion couplers)



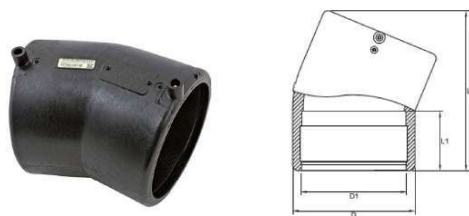

MATERIAL : PE 100

Ref	D1	D	L1	L
	mm	mm	mm	mm
EBKA90X225	90	113	72	214
EBKA110X225	110	143	71	232
EBKA125X225	125	165	86	274
EBKA160X225	160	209	86	302
EBKA180X225	180	244	105	391

Diâmetros de 200 - 1400 mm disponíveis como artigo composto (acessório topo a topo + uniões eletrosoldáveis).

Diameters from 200 - 1400 mm available as a kit (spigot fittings + electrofusion couplers)

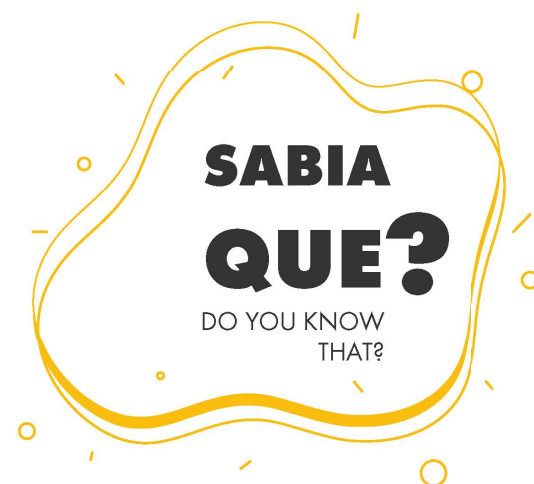

Os sistemas de polietileno são 100% recicláveis mesmo após cumprimento do tempo de serviço que se estima ser de 100 anos.

The polyethylene systems are 100% recycable even after its lifetime that is estimated to be 100 years.





CURVA A 45° 45° ELBOW

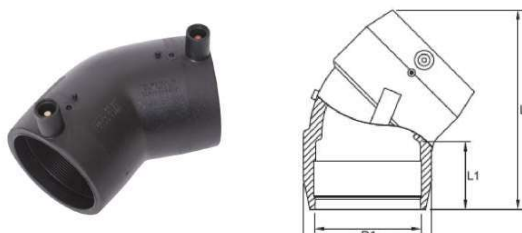

MATERIAL : PE 100

Ref.	D1	D	L1	L	PN
	mm	mm	mm	mm	bar
EBKA32X45	32	44	40	99	10 16
EBKA40X45	40	53	41.5	108	10 16
EBKA50X45	50	63	44.5	124	10 16
EBKA63X45	63	78.5	50	137	10 16
EBKA75X45	75	94	53	153	10 16
EBKA90X45	90	117	60	177	10 16
EBKA110X45	110	137	75	213	10 16
EBKA125X45	125	154	79	240	10 16
EBKA160X45	160	201	89	283	10 16
EBKA180X45	180	222	90	299	10 16
EBKA200X45	200	200	112	472	10 16
EBKA225X45	225	225	120	520	10 16
EBKA250X45	250	250	129	571	10 16

Diâmetros de 315 - 1400mm disponíveis como artigo composto [acessório topo a topo injetado (315-630mm) / segmentado (315-1400mm) + uniões eletrosoldáveis].

Diameters from 315 - 1400mm available as a kit [spigot fittings injected (315-630mm) / fabricated (315-1400mm)+ electrofusion couplers].





CURVA A 90° 90° ELBOW

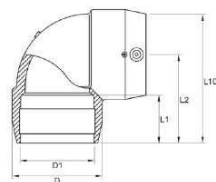

DISPONÍVEL
ALSO AVAILABLE



MATERIAL : PE 100

Ref.	D1	D	L	L1	L2	PN
	mm	mm	mm	mm	mm	bar
EBKA20X90	20	30	77	40	62	10 16
EBKA25X90	25	35	76	41	60	10 16
EBKA32X90	32	44	84	40	62	10 16
EBKA40X90	40	52	91	42	65	10 16
EBKA50X90	50	63	103	45	72	10 16
EBKA63X90	63	81	123	50	84	10 16
EBKA75X90	75	95	141	53	92	10 16
EBKA90X90	90	113	165	60	109	10 16
EBKA110X90	110	137	204	73	135	10 16
EBKA125X90	125	154	228	78	152	10 16
EBKA160X90	160	201	305	87	205	10 16
EBKA180X90	180	222	308	90	197	10 16
EBKA200X90	200	262	449	112	213	10 16
EBKA225X90	225	295	498	121	239	10 16
EBKA250X90	250	327	550	130	257	10 16

Diâmetros de 315 - 1400mm disponíveis como artigo composto [acessório topo a topo injetado (315-630mm) / segmentado (315-1400mm) + uniões eletrosoldáveis].

Diameters from 315 - 1400mm available as a kit [spigot fittings injected (315-630mm) / fabricated (315-1400mm)+ electrofusion couplers].



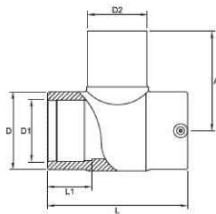

OPÇÃO SAÍDA FLANGEADA
FLANGED OUTLET



MATERIAL : PE 100

Ref.	D1	D	D2	L	L1	A	PN
	mm	mm	mm	mm	mm	mm	bar
ETBKA20	20	30	20	98	30	86	10 16
ETBKA25	25	35	25	98	30	88,5	10 16
ETBKA32	32	44	32	98	30	93	10 16
ETBKA40	40	52	40	131	44	91	10 16
ETBKA50	50	63	50	141	43	104	10 16
ETBKA63	63	82	63	156	50	114	10 16
ETBKA75	75	100	75	174	55	134	10 16
ETBKA90	90	115	90	206	64	143	10 16
ETBKA110	110	139	110	239	73	157	10 16
ETBKA125	125	156	125	264	80	182	10 16
ETBKA160	160	200	160	313	89	211	10 16
ETBKA180	180	222	180	334	90	232	10 16
ETBKA200	200	242	200	451	90	260	10 16
ETBKA225	225	271	225	494	105	285	10 16
ETBKA250	250	303	250	538	105	314	10 16

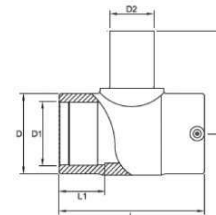

OPÇÃO SAÍDA FLANGEADA
FLANGED OUTLET



MATERIAL : PE 100

Ref.	D1	D2	D	L	L1	A	PN
	mm	mm	mm	mm	mm	mm	bar
RTBKA20X32	20	32	44	98	35	78	10 16
RTBKA25X20	25	20	44	104	39	66	10 16
RTBKA25X32	25	32	44	98	35	78	10 16
RTBKA32X20	32	20	44	104	39	66	10 16
RTBKA32X25	32	25	44	104	39	66	10 16
RTBKA40X20	40	20	56	120	43	72	10 16
RTBKA40X25	40	25	56	120	43	72	10 16
RTBKA40X32	40	32	56	120	43	75	10 16
RTBKA50X20	50	20	68	139	48	78	10 16
RTBKA50X25	50	25	68	139	48	78	10 16
RTBKA50X32	50	32	68	139	48	86	10 16
RTBKA50X40	50	40	67	144	49	101	10 16
RTBKA63X20	63	20	82	167	49	85	10 16
RTBKA63X32	63	20	82	167	58	93	10 16
RTBKA63X40	63	40	81	154	34	108	10 16
RTBKA63X50	63	50	83	157	51	118	10 16
RTBKA75X63	75	63	96	196	63	122	10 16
RTBKA90X63	90	63	116	206	63	138	10 16
RTBKA110X63	110	63	142	239	73	147	10 16
RTBKA110X90	110	90	139	239	73	162	10 16





Ref.	D1	D2	D	L	L1	A	PN
	mm	mm	mm	mm	mm	mm	bar
RTBKA125X63	125	63	157	266	79	500	10 16
RTBKA125X90	125	90	156	264	80	196	10 16
RTBKA125X110	125	110	156	262	76	359	10 16
RTBKA160X63	160	63	210	365	112	385	10 16
RTBKA160X90	160	90	210	365	112	385	10 16
RTBKA160X110	160	110	200	313	89	202	10 16
RTBKA160X125	160	125	213	365	112	410	10 16
RTBKA180X90	180	90	245	422	106	200	10 16
RTBKA180X110	180	110	245	422	106	219	10 16
RTBKA180X125	180	125	222	330	90	222	10 16
RTBKA180X140	180	140	245	422	106	237	10 16
RTBKA180X160	180	160	245	422	106	250	10 16
RTBKA200X90	200	90	261	451	114	205	10 16
RTBKA200X110	200	110	261	451	114	210	10 16
RTBKA225X90	225	90	293	494	122	220	10 16
RTBKA225X110	225	110	293	494	122	225	10 16
RTBKA250X90	250	90	326	538	129	250	10 16
RTBKA250X110	250	110	326	538	129	240	10 16

Diâmetros de 315 - 1400mm disponíveis como artigo composto
[acessório topo a topo injetado (315-630mm) / segmentado (315-1400mm) +
uniões eletrosoldáveis].

Diameters from 315 - 1400mm available as a kit [spigot fittings injected
(315-630mm) / fabricated (315-1400mm)+ eletrofusion couplers].





TOMADA EM CARGA MULTISEAL STACKLOAD MULTISEAL TAPPING TEE STACKLOAD

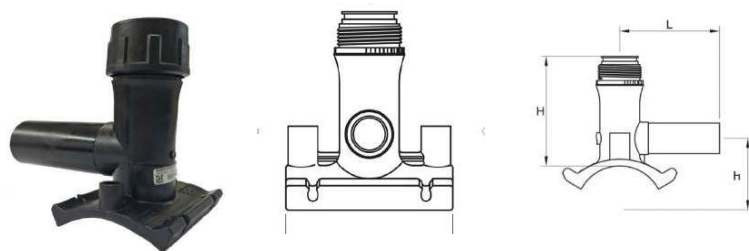

MATERIAL : PE 100

Ref.	D	L	H	h	W	PN
	mm	mm	mm	mm	mm	bar
MTBKA63X20	63 x 20	105	119	62	120	10 16
MTBKA63X25	63 x 25	105	119	62	120	10 16
MTBKA63X32	63 x 32	105	119	62	120	10 16
MTBKA75X20	75 x 20	105	110	77	120	10 16
MTBKA75X25	75 x 25	105	110	77	120	10 16
MTBKA75X32	75 x 32	105	110	77	120	10 16
MTBKA90X20	90 x 20	105	110	77	120	10 16
MTBKA90X25	90 x 25	105	110	77	120	10 16
MTBKA90X32	90 x 32	105	110	77	120	10 16
MTBKA110X20	110 x 20	105	117	87	120	10 16
MTBKA110X25	110 x 25	105	117	87	120	10 16
MTBKA110X32	110 x 32	105	117	87	120	10 16
MTBKA125X20	125 x 20	105	117	95	120	10 16
MTBKA125X25	125 x 25	105	117	95	120	10 16
MTBKA125X32	125 x 32	105	117	95	120	10 16
MTBKA160X20	160 x 20	105	122	112	120	10 16
MTBKA160X25	160 x 25	105	122	112	120	10 16
MTBKA160X32	160 x 32	105	122	112	120	10 16
MTBKA180X20	180 x 20	105	122	122	120	10 16
MTBKA180X25	180 x 25	105	122	122	120	10 16
MTBKA180X32	180 x 32	105	122	122	120	10 16
MTBKA200X20	200 x 20	105	122	132	120	10 16
MTBKA200X25	200 x 25	105	122	132	120	10 16
MTBKA200X32	200 x 32	105	122	132	120	10 16
MTBKA225X20	225 x 20	105	122	145	120	10 16
MTBKA225X25	225 x 25	105	122	145	120	10 16

Ref.	D	L	H	h	W	PN
	mm	mm	mm	mm	mm	bar
MTBKA225X32	225 x 32	105	122	145	120	10 16
MTBKA250X20	250 x 20	105	122	158	120	10 16
MTBKA250X25	250 x 25	105	122	158	120	10 16
MTBKA250X32	250 x 32	105	122	158	120	10 16
MTBKA280X20	280 x 20	105	122	176	120	10 16
MTBKA280X25	280 x 25	105	122	176	120	10 16
MTBKA280X32	280 x 32	105	122	176	120	10 16
MTBKA315X20	315 x 20	105	122	194	120	10 16
MTBKA315X25	315 x 25	105	122	194	120	10 16
MTBKA315X32	315 x 32	105	122	194	120	10 16
MTBKA355X20	355 x 20	105	122	214	120	10 16
MTBKA355X25	355 x 25	105	122	214	120	10 16
MTBKA355X32	355 x 32	105	122	214	120	10 16
MTBKA250X63	250 x 63	165	183	182	120	10 16
MTBKA280X63	280 x 63	165	184	196	120	10 16
MTBKA315X63	315 x 63	165	187	217	120	10 16
MTBKA355X63	355 x 63	165	187	238	120	10 16
MTBKA400/450 x 63	400/450 x 63	165	185	258 / 283	120	10 16

Acessório com saída a 40 e 50 mm disponíveis sob pedido
40 and 50 mm Outlet available upon request

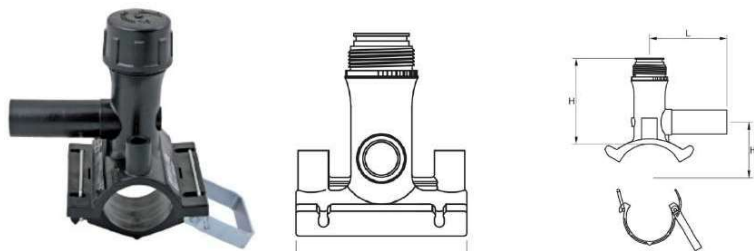

MATERIAL : PE 100

Ref.	D	L	H	h	W	PN
	mm	mm	mm	mm	mm	bar
MTBKA40X20	40 x 20	105	110	50	120	10 16
MTBKA40X25	40 x 25	105	110	50	120	10 16
MTBKA40X32	40 x 32	105	110	50	120	10 16
MTBKA50X20	50 x 20	105	110	50	120	10 16
MTBKA50X25	50 x 25	105	110	50	120	10 16
MTBKA50X32	50 x 32	105	110	50	120	10 16
MTBKA63X20	63 x 20	105	119	62	120	10 16
MTBKA63X25	63 x 25	105	119	62	120	10 16
MTBKA63X32	63 x 32	105	119	62	120	10 16
MTBKA63X40	63 x 40	165	155	60	146	10 16
MTBKA63X50	63 x 50	165	155	60	146	10 16
MTBKA63X63	63 x 63	165	155	60	146	10 16
MTBKA75X20	75 x 20	105	110	77	120	10 16
MTBKA75X25	75 x 25	105	110	77	120	10 16
MTBKA75X32	75 x 32	105	110	77	120	10 16
MTBKA75X40	75 x 40	165	152	57	146	10 16
MTBKA75X50	75 x 50	165	152	57	146	10 16
MTBKA75X63	75 x 63	165	152	57	146	10 16
MTBKA90X20	90 x 20	105	110	77	120	10 16
MTBKA90X25	90 x 25	105	110	77	120	10 16
MTBKA90X32	90 x 32	105	110	77	120	10 16
MTBKA90X40	90 x 40	165	152	57	146	10 16
MTBKA90X50	90 x 50	165	152	57	146	10 16
MTBKA90X63	90 x 63	165	152	57	146	10 16
MTBKA110X20	110 x 20	105	117	87	120	10 16
MTBKA110X25	110 x 25	105	117	87	120	10 16
MTBKA110X32	110 x 32	105	117	87	120	10 16
MTBKA110X40	110 x 40	165	176	105	146	10 16
MTBKA110X50	110 x 50	165	176	105	146	10 16

MTBKA110X63	110 x 63	165	176	105	146	10 16
MTBKA125X20	125 x 20	105	117	95	120	10 16
MTBKA125X25	125 x 25	105	117	95	120	10 16
MTBKA125X32	125 x 32	105	117	95	120	10 16
MTBKA125X40	125 x 40	165	178	112	146	10 16
MTBKA125X50	125 x 50	165	178	112	146	10 16
MTBKA125X63	125 x 63	165	178	112	146	10 16
MTBKA140X32	140 x 32	132	177	126	120	10 16
MTBKA140X40	140 x 40	142	177	130	146	10 16
MTBKA140X50	140 x 50	123	177	134	146	10 16
MTBKA140X63	140 x 63	175	177	134	146	10 16
MTBKA160X20	160 x 20	105	122	112	120	10 16
MTBKA160X25	160 x 25	105	122	112	120	10 16
MTBKA160X32	160 x 32	105	122	112	120	10 16
MTBKA160X40	160 x 40	165	182	137	146	10 16
MTBKA160X50	160 x 50	165	182	137	146	10 16
MTBKA160X63	160 x 63	165	182	137	146	10 16
MTBKA180X20	180 x 20	105	122	122	120	10 16
MTBKA180X25	180 x 25	105	122	122	120	10 16
MTBKA180X32	180 x 32	105	122	122	120	10 16
MTBKA180X40	180 x 40	165	183	147	146	10 16
MTBKA180X50	180 x 50	165	183	147	146	10 16
MTBKA180X63	180 x 63	165	183	147	146	10 16
MTBKA200X20	200 x 20	105	122	132	120	10 16
MTBKA200X25	200 x 25	105	122	132	120	10 16
MTBKA200X32	200 x 32	105	122	132	120	10 16
MTBKA200X40	200 x 40	165	183	157	146	10 16
MTBKA200X50	200 x 50	165	183	157	146	10 16
MTBKA200X63	200 x 63	165	183	157	146	10 16
MTBKA225X20	225 x 20	105	122	145	120	10 16
MTBKA225X25	225 x 25	105	122	145	120	10 16
MTBKA225X32	225 x 32	105	122	145	120	10 16
MTBKA225X40	225 x 40	165	183	169	146	10 16
MTBKA225X50	225 x 50	165	183	169	146	10 16
MTBKA225X63	225 x 63	165	183	169	146	10 16
MTBKA250X20	250 x 20	125	177	175	120	10 16
MTBKA250X32	250 x 32	132	177	181	120	10 16
MTBKA250X40	250 x 40	142	177	185	146	10 16
MTBKA250X50	250 x 50	123	177	189	146	10 16
MTBKA250X63	250 x 63	175	177	189	146	10 16



TOMADA EM CARGA FLEXTEE COM SELA INFERIOR FLEXTEE TAPPING TEE UNDERCLAMP

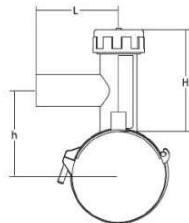
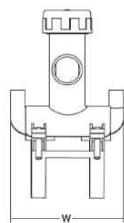

MATERIAL : PE 100

Ref.	D	L	H	h	W	PN
	mm	mm	mm	mm	mm	bar
FLTBKA40X20	40 x 20	83	100	45.5	112	10 16
FLTBKA40X25	40 x 25	83	100	45.5	112	10 16
FLTBKA40X32	40 x 32	83	100	45.5	112	10 16
FLTBKA50X20	50 x 20	83	100	51.5	112	10 16
FLTBKA50X25	50 x 25	83	100	51.5	112	10 16
FLTBKA50X32	50 x 32	83	100	51.5	112	10 16
FLTBKA63X20	63 x 20	82	100	59.5	119	10 16
FLTBKA63X25	63 x 25	82	100	59.5	119	10 16
FLTBKA63X32	63 x 32	82	100	59.5	119	10 16
FLTBKA75X20	75 x 20	82	100	65.5	119	10 16
FLTBKA75X25	75 x 25	82	100	65.5	119	10 16
FLTBKA75X32	75 x 32	82	100	65.5	119	10 16
FLTBKA90X20	90 x 20	82	100	73	119	10 16
FLTBKA90X25	90 x 25	82	100	73	119	10 16
FLTBKA90X32	90 x 32	82	100	73	119	10 16
FLTBKA110X20	110 x 20	92	100	83	119	10 16
FLTBKA110X25	110 x 25	92	100	83	119	10 16
FLTBKA110X32	110 x 32	92	100	83	119	10 16
FLTBKA125X20	125 x 20	92	100	90.5	119	10 16
FLTBKA125X25	125 x 25	92	100	90.5	119	10 16
FLTBKA125X32	125 x 32	92	100	90.5	119	10 16
FLTBKA160X20	160 x 20	92	100	108	119	10 16
FLTBK160X25	160 x 25	92	100	108	119	10 16
FLTBKA160X32	160 x 32	92	100	108	119	10 16
FLTBKA180X20	180 x 20	92	100	118	119	10 16
FLTBKA180X25	180 x 25	92	100	118	119	10 16
FLTBKA180X32	180 x 32	92	100	118	119	10 16

TOMADA SIMPLES STACKLOAD BRANCH SADDLE STACKLOAD

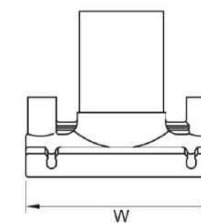
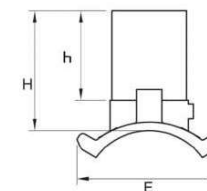

Ref.	D	H	h	W	E	PN
	mm	mm	mm	mm	mm	bar
BBKA250X63	250 x 63	125	75	146	122	10 16
BBKA280X63	280 x 63	140	75	146	122	10 16
BBKA315X63	315 x 63	140	75	146	122	10 16
BBKA355X63	355 x 63	140	75	146	122	10 16
BBKA400/450X63	400/450 x 63	146	72	146	152	10 16

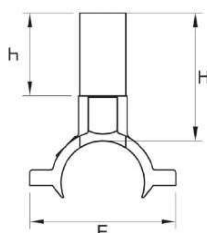
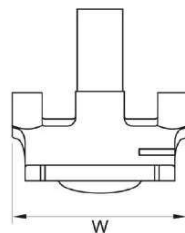

MATERIAL : PE 100

Ref.	D	H	h	W	PN
	mm	mm	mm	mm	bar
BBKA40X20	40 x 20	93	51	103	10 16
BBKA40X25	40 x 25	90	52	103	10 16
BBKA40X32	40 x 32	90	57	103	10 16
BBKA63X20	63 x 20	90	50	122	10 16
BBKA63X25	63 x 25	106	59	122	10 16
BBKA63X32	63 x 32	106	59	122	10 16
BBKA90X20	90 x 20	91	51	136	10 16
BBKA90X25	90 x 25	91	51	136	10 16
BBKA90X32	90 x 32	91	51	136	10 16
BBKA90X40	90 x 40	105	69	136	10 16
BBKA90X50	90 x 50	105	82	136	10 16
BBKA90X63	90 x 63	105	88	136	10 16

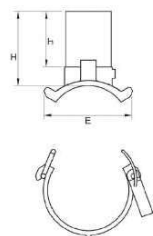
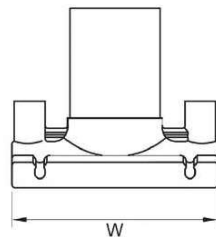

BBKA63X40	63 x 40	115	75	147	10 16
BBKA63X50	63 x 50	115	75	147	10 16
BBKA63X63	63 x 63	115	75	147	10 16
BBKA75X40	75 x 40	115	75	147	10 16
BBKA75X50	75 x 50	115	75	147	10 16
BBKA75X63	75 x 63	115	75	147	10 16
BBKA90X40	90 x 40	115	75	147	10 16
BBKA90X50	90 x 50	115	75	147	10 16

BBKA90X63	90 x 63	115	75	147	10 16
BBKA110X50	110 x 40	118	75	147	10 16
BBKA110X41	110 x 50	118	75	147	10 16
BBKA110X63	110 x 63	118	75	147	10 16
BBKA125X40	125 x 40	118	75	147	10 16
BBKA125X50	125 x 50	118	75	147	10 16
BBKA125X63	125 x 63	118	75	147	10 16
BBKA160X40	160 x 40	125	75	147	10 16
BBKA160X50	160 x 50	125	75	147	10 16
BBKA160X63	160 x 63	125	75	147	10 16
BBKA180X40	180 x 40	125	75	147	10 16
BBKA180X50	180 x 50	125	75	147	10 16
BBKA180X63	180 x 63	125	75	147	10 16
BBKA200X40	200 x 40	125	75	147	10 16
BBKA200X50	200 x 50	125	75	147	10 16
BBKA200X63	200 x 63	125	75	147	10 16
BBKA225X40	225 x 40	125	75	147	10 16
BBKA225X50	225 x 50	125	75	147	10 16
BBKA225X63	225 x 63	125	75	147	10 16

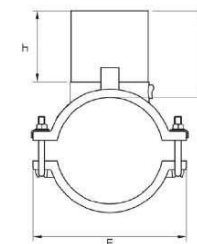
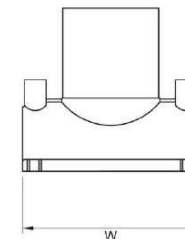

BBKA90X90	90 x 90	124	84	144	10 16
BBKA110X90	110 x 90	121	84	165	10 16
BBKA125X90	125 x 90	114	84	165	10 16
BBKA160X90	160 x 90	110	84	215	10 16
BBKA180X90	180 x 90	100	84	215	10 16
BBKA200X90	200 x 90	115	84	165	10 16
BBKA225X90	225 x 90	113	84	165	10 16
BBKA250X90	250 x 90	120	84	165	10 16
BBKA160X110	160 x 110	131	98	217	10 16
BBKA180X110	180 x 110	121	98	217	10 16
BBKA180X125	180 x 125	121	98	217	10 16
BBKA225X125	225 x 125	123	98	310	10 16
BBKA250X125	250 x 125	110	98	310	10 16

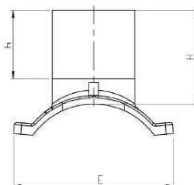
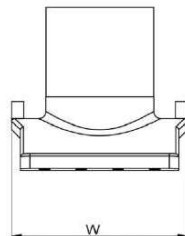

Ref.	D	H	h	W	PN
	mm	mm	mm	mm	bar
BBKA315X110	315 x 110	242	150	300	10 16
BBKA315X125	315 x 125	242	150	300	10 16
BBKA315X160	315 x 160	194	150	300	10 16
BBKA315X180	315 x 180	194	150	300	10 16
BBKA355X110	355 x 110	242	150	300	10 16
BBKA355X125	355 x 125	216	150	300	10 16
BBKA355X160	355 x 160	188	150	300	10 16
BBKA355X180	355 x 180	188	150	300	10 16
BBKA400X110	400 x 110	193	150	300	10 16
BBKA400X125	400 x 125	190	150	300	10 16
BBKA400X160	400 x 160	190	150	300	10 16
BBKA400X180	400 x 180	190	150	300	10 16
BBKA500X110	500 x 110	190	150	300	10 16
BBKA500X125	500 x 125	190	150	300	10 16
BBKA500X160	500 x 160	190	150	300	10 16
BBKA500X180	500 x 180	190	150	300	10 16
BBKA630X110	630 x 110	193	150	300	10 16
BBKA630X125	630 x 125	193	150	300	10 16
BBKA630X160	630 x 160	193	150	300	10 16
BBKA630X180	630 x 180	193	150	300	10 16

Opção com saída flangeada, disponíveis sob pedido.

Flanged Branch Saddle, available on request.



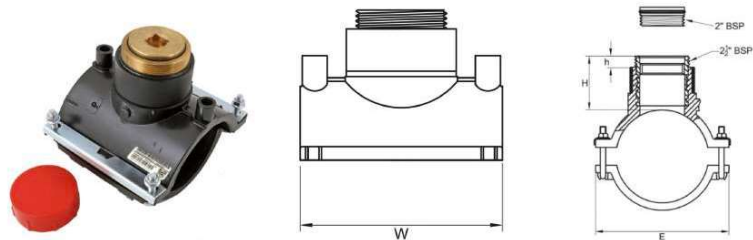

MATERIAL : PE 100

Ref.	D	H	h	W	E	PN
	mm	mm	mm	mm	mm	bar
XBBKA90X21/2	90 X 2 1/2"	71	15	167	154	10 16
XBBKA110X21/2	110 X 2 1/2"	72	15	166	180	10 16
XBBKA125X21/2	125 X 2 1/2"	72.5	15	166	180	10 16
XBBKA140X21/2	140 X 2 1/2"	84	15	215	236	10 16
XBBKA160X21/2	160 X 2 1/2"	84	15	215	236	10 16
XBBKA180X21/2	180 X 2 1/2"	74	15	215	263	10 16
XBBKA200X21/2	200 X 2 1/2"	82	15	166	263	10 16
XBBKA225X21/2	225 X 2 1/2"	80	15	166	291	10 16
XBBKA250X21/2	250 X 2 1/2"	86	15	166	317	10 16

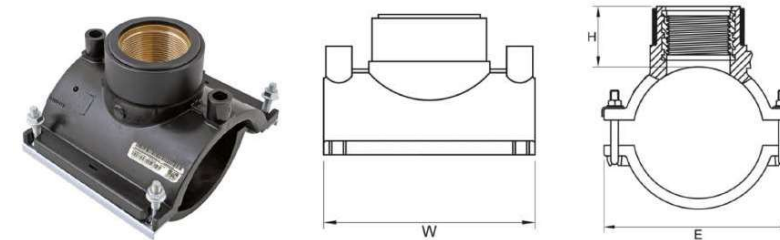

MATERIAL : PE 100

Ref.	D	H	W	E
	mm	mm	mm	mm
XBBKA63X11/4	63 X 1 1/4"	90	118	102
XBBKA75X11/4	75 X 1 1/4"	53	118	117
XBBKA90X11/4	90 X 1 1/4"	57	167	156
XBBKA90X11/2	90 X 1 1/2"	57	167	156
XBBKA90X2	90 X 2"	57	167	156
XBBKA110X11/4	110 X 1 1/4"	56	166	180
XBBKA110X11/2	110 X 1 1/2"	56	166	180
XBBKA110X2	110 X 2"	56	166	180
XBBKA125X11/4	125 X 1 1/4"	58	166	180
XBBKA125X11/2	125 X 1 1/2"	58	166	180
XBBKA125X2	125 X 2"	58	166	180
XBBKA140X11/2	140 X 1 1/2"	53	118	175
XBBKA140X2	140 X 2"	76	176	174
XBBKA160X11/4	160 X 1 1/4"	84	215	236
XBBKA160X11/2	160 X 1 1/2"	84	215	236
XBBKA160X2	160 X 2"	84	215	236
XBBKA180X11/4	180 X 1 1/4"	74	215	236
XBBKA180X11/2	180 X 1 1/2"	74	215	236
XBBKA180X2	180 X 2"	74	215	236
XBBKA200X2	200 X 2"	82	166	263
XBBKA225X2	225 X 2"	80	166	300
XBBKA250X2	250 X 2"	86	166	317
XBBKA(DN)X2	280 - 400 X 2"	77	306	300
XBBKA(DN)X2	450 - 710 X 2"	77	314	300



TOMADAS ELETROSOLDÁVEIS DE DERIVAÇÃO XL GRANDE DIÂMETRO XL ELECTROFUSION BRANCH SADDLE LARGE DIAMETER



TOMADA DE DERIVAÇÃO SIMPLES XL XL BRANCH SADDLE

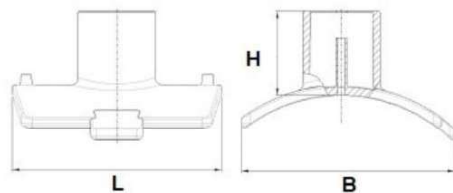

MATERIAL : PE 100

Ref	D	B	H	L	PN
	mm	mm	mm	mm	bar
BBKA(DN)X90XL	250 - 400 X 90	305	115	300	10 16
BBKA(DN)X110XL	250 - 400 X 110	305	117	300	10 16
BBKA(DN)X125XL	250 - 400 X 125	305	121	300	10 16
BBKA(DN)X160XL	250 - 400 X 160	305	132	300	10 16
BBKA(DN)X90XL	450 - 800 X 90	315	117	300	10 16
BBKA(DN)X110XL	450 - 800 X 110	315	117	300	10 16
BBKA(DN)X125XL	450 - 800 X 125	315	117	300	10 16
BBKA(DN)X160XL	450 - 800 X 160	315	130	300	10 16

TOMADA DE DERIVAÇÃO FLANGEADA XL XL FLANGED BRANCH SADDLE

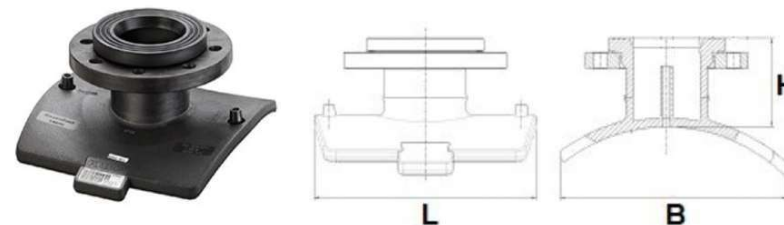

MATERIAL : PE 100

Ref.	D	B	H	L	PN
	mm	mm	mm	mm	bar
BBKA(DN)X80XL	250 - 400 X DN80	305	115	300	10 16
BBKA(DN)X100XL	250 - 400 X DN100	305	117	300	10 16
BBKA(DN)X150XL	250 - 400 X DN150	305	121	300	10 16
BBKA(DN)X80XL	450 - 800 X DN80	315	117	300	10 16
BBKA(DN)X100XL	450 - 800 X DN100	315	117	300	10 16
BBKA(DN)X150XL	450 - 800 X DN150	315	117	300	10 16

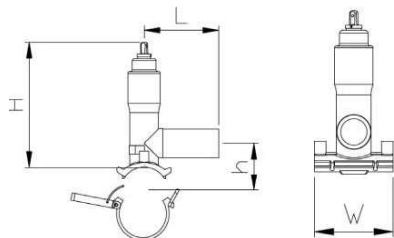

MATERIAL : PE 100

Ref.	D	L	H	h	PN
	mm	mm	mm	mm	bar
TVBKA63X32	63 x 32	165	250	59.5	10 16
TVBKA63X40	63 x 40	165	250	59.5	10 16
TVBKA63X50	63 x 50	165	250	59.5	10 16
TVBKA63X63	63 x 63	165	250	59.5	10 16
TVBKA75X32	75 x 32	165	250	57	10 16
TVBKA75X40	75 x 40	165	250	57	10 16
TVBKA75X50	75 x 50	165	250	57	10 16
TVBKA75X63	75 x 63	165	250	57	10 16
TVBKA90X32	90 x 32	165	250	57	10 16
TVBKA90X40	90 x 40	165	250	57	10 16
TVBKA90X50	90 x 50	165	250	57	10 16
TVBKA90X63	90 x 63	165	250	57	10 16
TVBKA110X32	110 x 32	165	269	105	10 16
TVBKA110X40	110 x 40	165	269	105	10 16
TVBKA110X50	110 x 50	165	269	105	10 16
TVBKA110X63	110 x 63	165	269	105	10 16
TVBKA125X32	125 x 32	165	269	112	10 16
TVBKA125X40	125 x 40	165	269	112	10 16
TVBKA125X50	125 x 50	165	269	112	10 16
TVBKA125X63	125 x 63	165	269	112	10 16
TVBKA140X32	140 x 32	126	244	116	10 16
TVBKA140X40	140 x 40	137	244	116	10 16
TVBKA140X50	140 x 50	152	244	121	10 16
TVBKA140X63	140 x 63	186	244	121	10 16
TVBKA160X32	160 x 32	165	272	137	10 16
TVBKA160X40	160 x 40	165	272	137	10 16
TVBKA160X50	160 x 50	165	272	137	10 16

TVBKA160X63	160 x 63	165	272	137	10 16
TVBKA180X32	180 x 32	165	272	147	10 16
TVBKA180X40	180 x 40	165	272	147	10 16
TVBKA180X50	180 x 50	165	272	147	10 16
TVBKA180X63	180 x 63	165	272	147	10 16
TVBKA200X32	200 x 32	165	272	157	10 16
TVBKA200X40	200 x 40	165	272	157	10 16
TVBKA200X50	200 x 50	165	272	157	10 16
TVBKA200X63	200 x 63	165	272	157	10 16
TVBKA225X32	225 x 32	165	272	169	10 16
TVBKA225X40	225 x 40	165	272	169	10 16
TVBKA225X50	225 x 50	165	272	169	10 16
TVBKA225X63	225 x 63	165	272	169	10 16
TVBKA250X32	250 x 32	126	244	171	10 16
TVBKA250X40	250 x 40	137	244	171	10 16
TVBKA250X50	250 x 50	152	244	176	10 16
TVBKA250X63	250 x 63	186	244	176	10 16

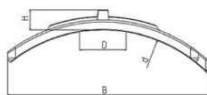
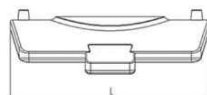

MATERIAL : PE 100

Ref.	D1	B	H	L	PN
	mm	mm	mm	mm	
ARBKA63	63	110	29	118	16
ARBKA75	75	117	29	118	16
ARBKA90	90	126	29	118	16
ARBKA110	110	148	29	118	16
ARBKA125	125	162	29	118	16
ARBKA140	140	180	29	118	16
ARBKA160	165	199	29	118	16
ARBKA180	180	219	29	118	16
ARBKA250-900	250-900	305	30	300	16

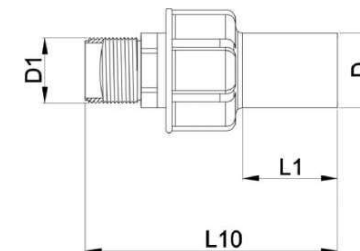

MATERIAL : PE 100

Ref	D x D1	L10 mm	L1 mm
INSERT20X1/2M	20 x 1/2"	92	38
INSERT25X3/4M	25 x 3/4"	99	40
INSERT32X1M	32 x 1"	110	44
INSERT40X1M	40 x 1"	110	49
INSERT40X1 1/2M	40 x 1 1/2"	121	49
INSERT40X1 1/4M	40 x 1 1/4"	121	49
INSERT50X1 1/2M	50 x 1 1/2"	134	54
INSERT63X1 1/2M	63 x 1 1/2"	465	73
INSERT63X2M	63 x 2"	150	63
INSERT75X2 1/2M	75 x 2 1/2"	165	73
INSERT90X3M	90 x 3"	181	82
INSERT110X4M	110 x 4"	194	84
INSERT125X4M	125 x 4"	202	92

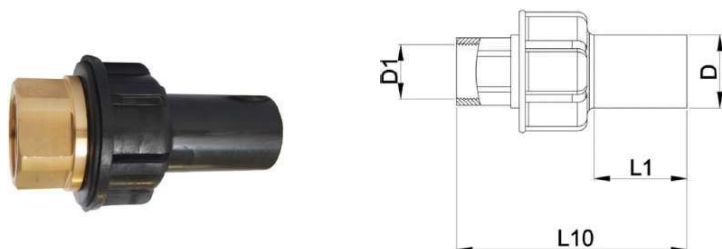

MATERIAL : PE 100

Ref.	D x D1	L10	L1
		mm	mm
INSERT20X1/2	20 x 1/2"	82	38
INSERT25X3/4	25 x 3/4"	91	40
INSERT32X1	32 x 1"	100	44
INSERT40X1	40 x 1"	109	44
INSERT40X11/2	40 x 1 1/2"	109	49
INSERT40X11/4	40 x 1 1/4"	109	49
INSERT50X11/2	50 x 1 1/2"	124	54
INSERT63X11/2	63 x 1 1/2"	165	73
INSERT63X2	63 x 2"	141	63
INSERT75X21/2	75 x 2 1/2"	163	73
INSERT90X3	90 x 3"	181	82
INSERT110X4	110 x 4"	190	84
INSERT125X4	125 x 4"	165	91

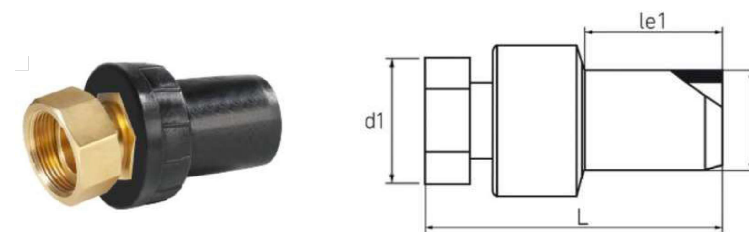

MATERIAL : PE 100

Ref.	d x d1	L	le1	PN
		mm	mm	bar
INSERT20X1/2	20 x 1/2"	109	44	10 16
INSERT25X1/2	25 x 1/2"	109	46	10 16
INSERT25X3/4	25 x 3/4"	112	44	10 16
INSERT32X3/4	32 x 3/4"	116	51	10 16
INSERT32X1	32 x 1"	118	48	10 16
INSERT40X1	40 x 1"	123	55	10 16
INSERT40X11/4	40 x 1 1/4"	135	53	10 16
INSERT50X11/2	50 x 1 1/2"	145	61	10 16
INSERT63X1	63 x 1"	143	77	10 16
INSERT63X2	63 x 2"	162	69	10 16

